

5-18/27

URZĄD GMINY MASZÓW
woj. świętokrzyskie
26-001 Maszów, ul. Spokojna 2
NIP 657 17 48 114

Załącznik nr. 1
DOMASZOWICE

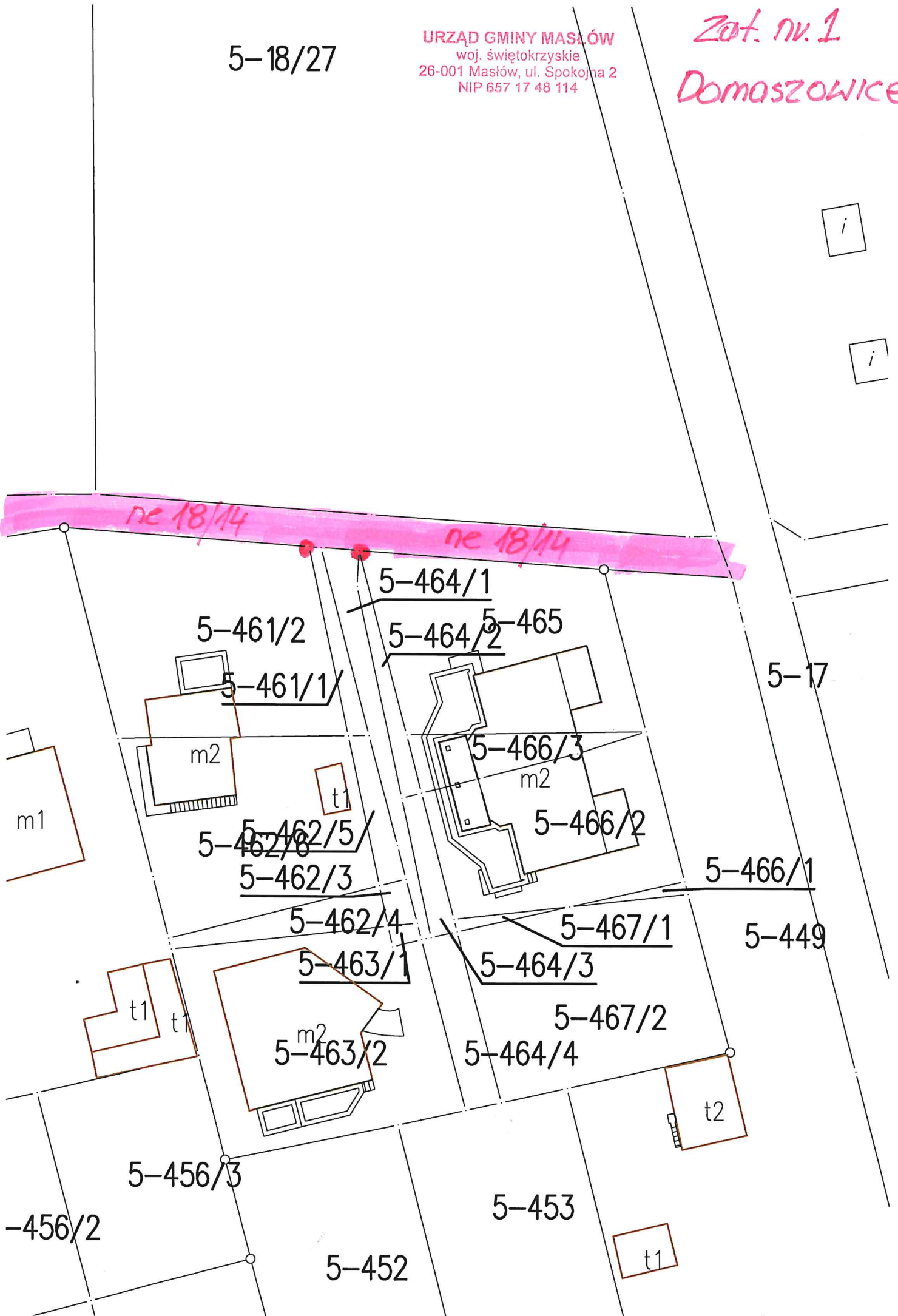

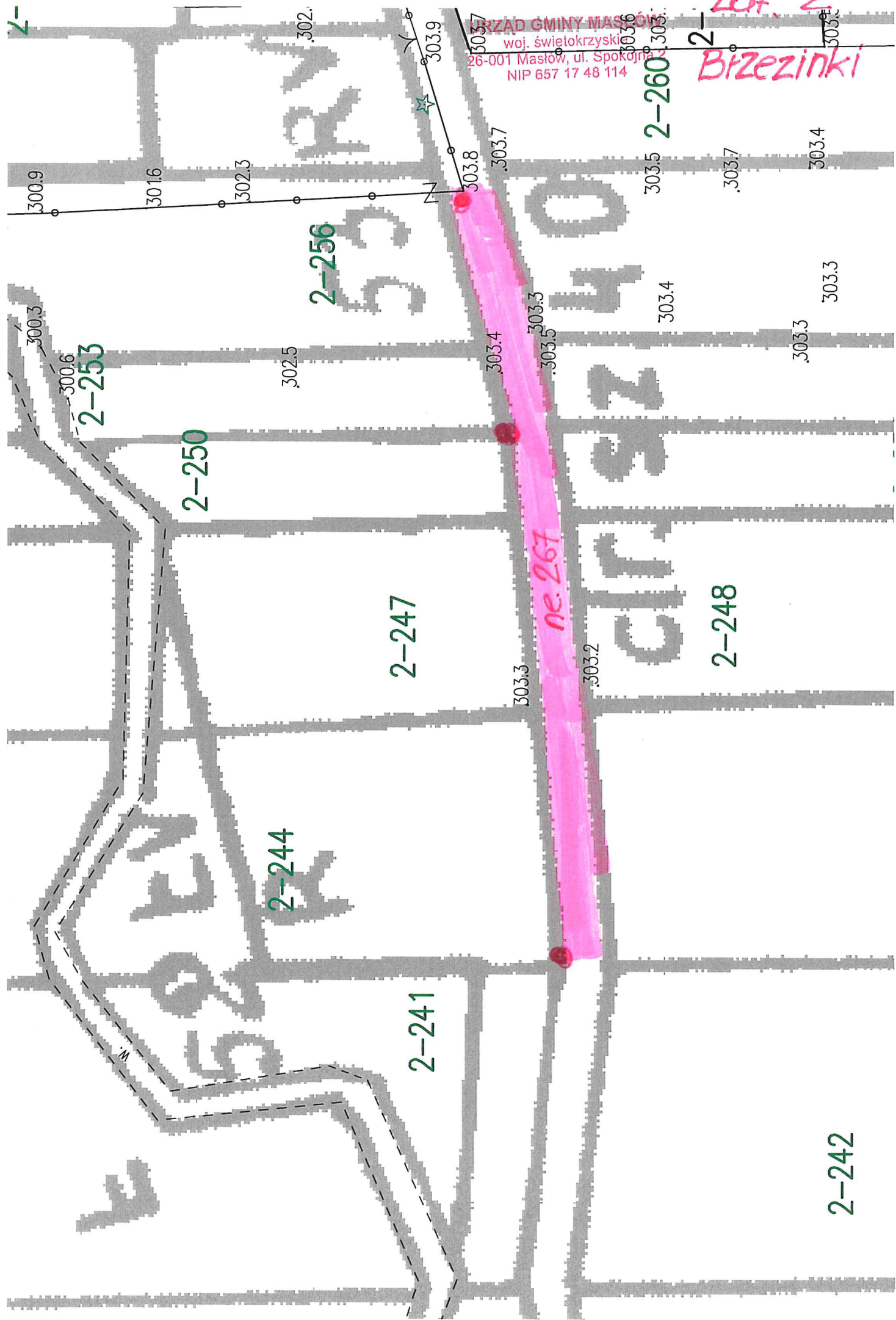

URZĄD GMINY MASŁÓW
woj. świętokrzyski
26-001 Masłów, ul. Spokojna 2
NIP 657 17 48 114

Załącznik 2
Brzezinki

2-247

2-250

2-253

2-256

2-244

2-241

2-248

2-242

nr. 267

300.9

301.6

302.3

302.

303.9

303.7

303.6

303.5

303.2

303.5

300.3

300.6

302.5

303.4

303.3

303.4

303.3

303.3

303.3

303.2

303.7

303.4

303.8

303.7

303.5

2-260

303.5

M

407.5
Domaszowice

URZĄD GMINY MARSZAŁKOWICE
województwo świętokrzyskie
26-001 M. Marszałkowice, ul. Spokojna 2
KIP 657 17 48 114

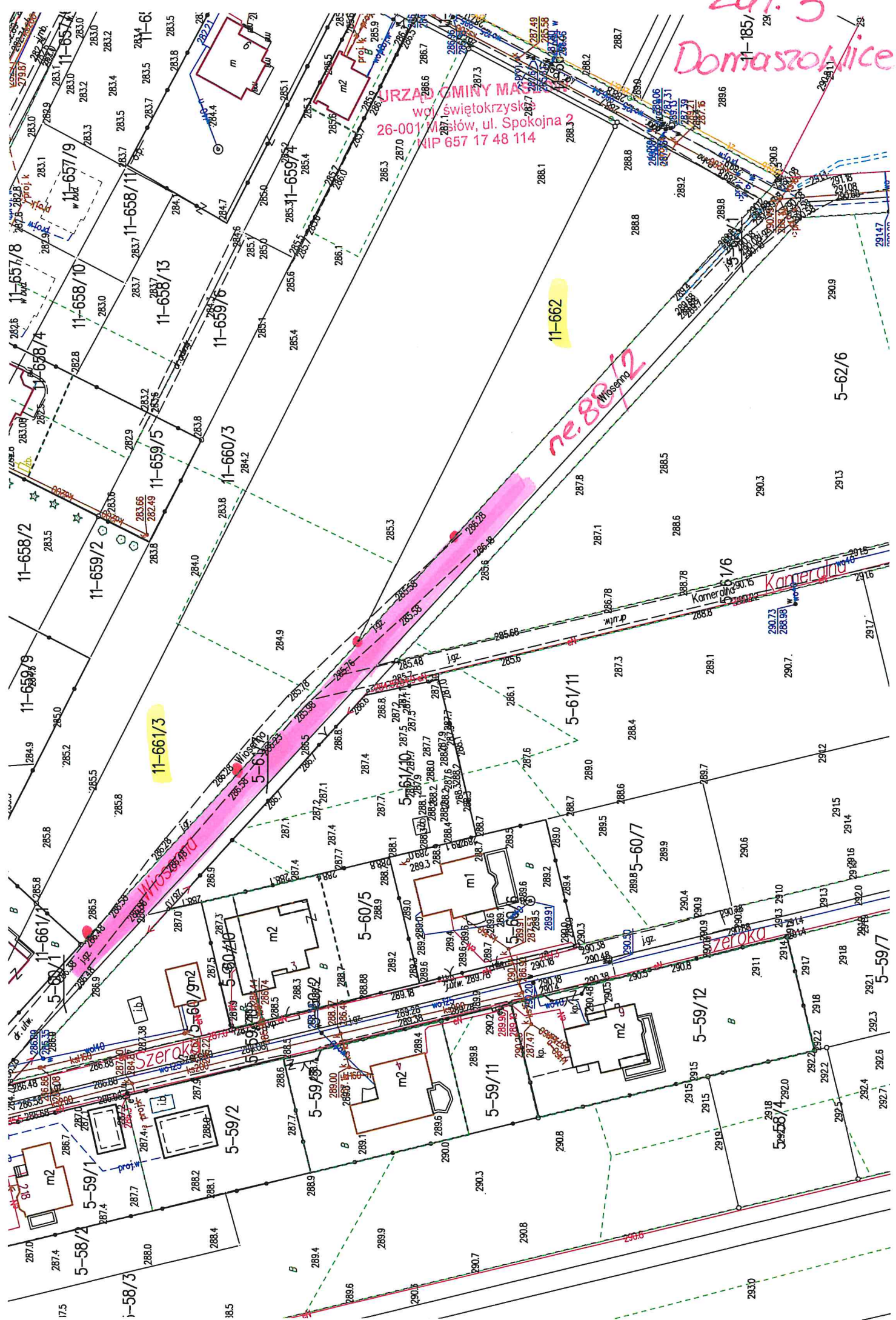

11-662

nr. 88/12

11-661/3

5-61/11

5-60/7

5-59/12

5-59/7

5-58/4

5-58/2

5-59/1

5-59/2

5-60/2

5-60/3

5-60/4

5-60/5

5-60/6

5-60/7

5-60/8

5-60/9

5-60/10

5-60/11

5-60/12

5-60/13

11-659/9

11-658/9

11-659/10

11-658/10

11-659/11

11-658/11

11-659/12

11-658/12

11-659/13

11-658/13

11-659/14

11-658/14

11-659/15

11-658/15

11-659/16

11-657/8

11-658/8

11-659/8

11-658/8

11-659/8

11-658/8

11-659/8

11-658/8

11-659/8

11-658/8

11-659/8

11-658/8

11-659/8

11-658/8

11-659/8

11-657/9

11-658/9

11-659/9

11-658/9

11-659/9

11-658/9

11-659/9

11-658/9

11-659/9

11-658/9

11-659/9

11-658/9

11-659/9

11-658/9

11-659/9

11-657/10

11-658/10

11-659/10

11-658/10

11-659/10

11-658/10

11-659/10

11-658/10

11-659/10

11-658/10

11-659/10

11-658/10

11-659/10

11-658/10

11-659/10

11-657/11

11-658/11

11-659/11

11-658/11

11-659/11

11-658/11

11-659/11

11-658/11

11-659/11

11-658/11

11-659/11

11-658/11

11-659/11

11-658/11

11-659/11

11-657/12

11-658/12

11-659/12

11-658/12

11-659/12

11-658/12

11-659/12

11-658/12

11-659/12

11-658/12

11-659/12

11-658/12

11-659/12

11-658/12

11-659/12

11-657/13

11-658/13

11-659/13

11-658/13

11-659/13

11-658/13

11-659/13

11-658/13

11-659/13

11-658/13

11-659/13

11-658/13

11-659/13

11-658/13

11-659/13

11-657/14

11-658/14

11-659/14

11-658/14

11-659/14

11-658/14

11-659/14

11-658/14

11-659/14

11-658/14

11-659/14

11-658/14

11-659/14

11-658/14

11-659/14

11-657/15

11-658/15

11-659/15

11-658/15

11-659/15

11-658/15

11-659/15

11-658/15

11-659/15

11-658/15

11-659/15

11-658/15

11-659/15

11-658/15

11-659/15

11-657/16

11-658/16

11-659/16

11-658/16

11-659/16

11-658/16

11-659/16

11-658/16

11-659/16

11-658/16

11-659/16

11-658/16

11-659/16

11-658/16

11-659/16

11-657/17

11-658/17

11-659/17

11-658/17

11-659/17

11-658/17

11-659/17

11-658/17

11-659/17

11-658/17

11-659/17

11-658/17

11-659/17

11-658/17

11-659/17

11-657/18

11-658/18

11-659/18

11-658/18

11-659/18

11-658/18

11-659/18

11-658/18

11-659/18

11-658/18

11-659/18

11-658/18

11-659/18

11-658/18

11-659/18

11-657/19

11-658/19

11-659/19

11-658/19

11-659/19

11-658/19

11-659/19

11-658/19

11-659/19

11-658/19

11-659/19

11-658/19

11-659/19

11-658/19

11-659/19

11-657/20

11-658/20

11-659/20

11-658/20

11-659/20

11-658/20

11-659/20

11-658/20

11-659/20

11-658/20

11-659/20

11-658/20

11-659/20

11-658/20

11-659/20

11-657/21

11-658/21

11-659/21

11-658/21

11-659/21

11-658/21

11-659/21

11-658/21

11-659/21

11-658/21

11-659/21

11-658/21

11-659/21

11-658/21

11-659/21

11-657/22

11-658/22

11-659/22

11-658/22

11-659/22

11-658/22

11-659/22

11-658/22

11-659/22

11-658/22

11-659/22

11-658/22

11-659/22

11-658/22

11-659/22

11-657/23

11-658/23

11-659/23

11-658/23

11-659/23

11-658/23

11-659/23

11-658/23

11-659/23

11-658/23

11-659/23

11-658/23

URZĄD GMINY MASŁÓW
woj. świętokrzyskie
26-001 Masłów, ul. Spokojna 2
NIP 657 17 48 114

Lot 4
Machocice
Kapitulne

8-



309.90

310.8

proj. k

310.46

proj. j.r

ok. nr. 745

309.51

310.53

nr. ew 731/15

308.75

309.98

ks21

309.91

307.18

